

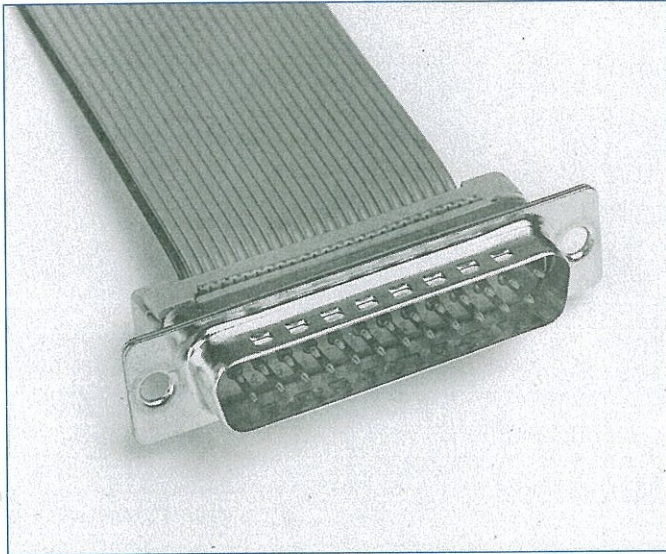

Superfast IDC D

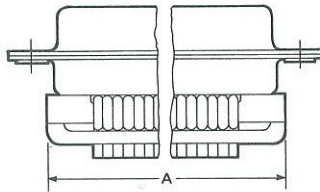

- High speed mass termination
- Low profile
- Steel shell for maximum strength
- Strain relief included
- Standard RS 232 interface
- UL 94V-0 rated insulators & strain relief
- Bright tin finish & grounding indents for EMI/RFI shielding
- Compatible with all other D Subminiatures
- Backshell & jack screws available.

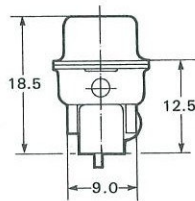

Number of Contacts	A
9	20.2
15	28.6
25	42.3
37	58.8

Technical Data

Termination Options	Insulation Displacement	Current rating	1A
Number of Contacts	9 15 25 37	Proof Voltage	1.05 Kv d.c. or a.c. peak
Maximum Insertion & Extraction Force	30 50 83 123N	Working Voltage	350V d.c. or a.c. peak
Performance Levels	2 or 3	Contact Resistance	$5 \times 10^{-3m} \Omega$ max
Wire Accommodation	26-28 AWG	Insulation Resistance	$\geq 1 \times 10^9 \Omega$
Plug Contact Material	Copper Alloy	Temperature Range	-55°C to +85°C Limited by PVC insulation on ribbon cable
Socket Contact Material	Copper Alloy	Insulator Materials	GF Polyester. UL 94V-0 Rated
		Shell Materials	Steel – Zinc plated or bright tin finish with grounding indents on plugs



Series Prefix: FC

Mounting Type: []

Contact Arrangement: - 25

Contact Type: P

Shell Finish: TI

Performance Level: []

Series Prefix	FC
Shell Size	E, A, B, C
Mounting Type	B - 4-40 rivnut for rear panel mounting F - Float mount bushes P - M3 rivnut for rear panel mounting No designation - Ø 3.05 mm mounting hole (90° PCB mount)
Contact Arrangement	9, 15, 25 or 37
Contact Type	P or S
Shell Finish	T - Bright tin TI - Bright tin with grounding indents (plugs only) No designation - Zinc plating with yellow chromate passivation
Performance Level	1 - DIN Class 1 No designation - Performance Level 2

*Unless expressly stated. Otherwise, backplate will be supplied assembled

Superfast IDC – Plug Best Sellers

Number of Contacts	Performance Level	Through Hole		Rear Panel Mount		Hoods
		Zinc Chromate Plated Shell	Tin Indent Plated Shell	4-40 Rivnut Tin indent Shell	M3 Rivnut Tin indent Shell	
9	1	FC-9P1	FC-9PT11	FCB-9PT11	FCP-9PT11	FC-9H
	2	FC-9P	FC-9PT1	FCB-9PT1	FCP-9PT1	
15	1	FC-15P1	FC-15PT11	FCB-15PT11	FCP-15PT11	FC-15H
	2	FC-15P	FC-15PT1	FCB-15PT1	FCP-15PT1	
25	1	FC-25P1	FC-25PT11	FCB-25PT11	FCP-25PT11	FC-25H
	2	FC-25P	FC-25PT1	FCB-25PT1	FCP-25PT1	
37	1	FC-37P1	FC-37PT11	FCB-37PT11	FCP-37PT11	FC-37H
	2	FC-37P	FC-37PT1	FCB-37PT1	FCP-37PT1	

Superfast IDC – Socket

Number of Contacts	Performance Level	Through Hole		Rear Panel Mount		Hoods
		Zinc Chromate Plated Shell	Tin Indent Plated Shell	4-40 Rivnut Tin indent Shell	M3 Rivnut Tin indent Shell	
9	1	FC-9S1	FC-9ST1	FCB-9ST1	FCP-9ST1	FC-9H
	2	FC-9S	FC-9ST	FCB-9ST	FCP-9ST	
15	1	FC-15S1	FC-15ST1	FCB-15ST1	FCP-15ST1	FC-15H
	2	FC-15S	FC-15ST	FCB-15ST	FCP-15ST	
25	1	FC-25S1	FC-25ST1	FCB-25ST1	FCP-25ST1	FC-25H
	2	FC-25S	FC-25ST	FCB-25ST	FCP-25S	
37	1	FC-37S1	FC-37ST1	FCB-37ST1	FCP-37ST1	FC-37H
	2	FC-37S	FC-37ST	FCB-37ST	FCP-37ST	